

Izmērs - A, B  
Biezums - T

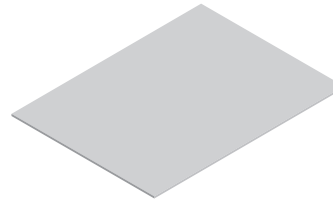

## KARSTI VELMĒTAS TĒRAUDA LOKSNES

Izmērs	Biezums, mm																			
AxB, mm	2	3	4	5	6	8	10	12	15	20	22	25	30	35	40	45	50	60	70	100
2000x1000	32	48	64	80	96	128	160	192	240	320		400	480	560	640	720	800	960	1120	1600
2500x1250	50	75	100	125	150	200	250	300	375	500	550	625	750	875	1000	1125	1250			
3000x1500	72	108	144	180	216	288	360	432	540	720		900	1080	1260	1440	1620	1800			
4000x2000	192	256	320	384	512	640	768	960	1280			1600	1920							
6000x2000		288	384	480	576	768	960	1152	1440	1920		2400								

Teorētiskais svars kg/m<sup>2</sup>

## AUKSTI VELMĒTAS TĒRAUDA LOKSNES

Izmērs	Biezums, T, mm									
AxB, mm	0,50	0,75	0,80	0,90	1,00	1,25	1,50	2,00	2,50	3,00
2000x1000	8	12	12,8	14,4	16	20	24	32	40	48
2500x1250	12,5	18,8	20	22,5	25	31,25	37,5	50	62,5	75
3000x1500					36	45	54	72	90	108

## KARSTI CINKOTA LOKSNE

Izmērs	Biezums, T, mm										
AxB, mm	0,50	0,75	0,80	0,90	1,00	1,25	1,50	2,00	2,50	3,00	4,00
2000x1000	9		14	15	16	21	25	33	41	49	65
2500x1250		20		24	26	32	39	51	63	76	102
3000x1500		28		34	37	46	55	74	91	111	147

## RIFLĒTA TĒRAUDA LOKSNE – ROMBVEIDA RAKSTS

Izmērs	Biezums, T, mm				
AxB, mm	3	4	5	6	8
2000x1000	55	73	87	103	135
2500x1250	86	115	136	161	211
3000x1500	114	152	196	228	304
6000x1500	228	304	392	456	608

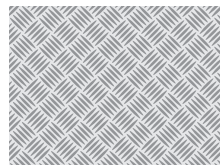

## RIFLĒTA TĒRAUDA LOKSNE – PILIENVEIDA RAKSTS

Izmērs	Biezums, T, mm			
AxB, mm	3	4	5	6
2000x1000	52	70	84	100
2500x1250	86	115	136	156
3000x1500	113	151	189	225
6000x1500	227	303	378	454

